

welcome to choose **Anwoll**.
Pls read the user manual before application.

AIR SWITCH SOCKET ASS62 SERIES

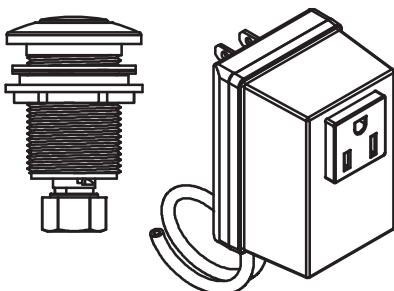

ASS62 is suitable for food waste disposal, swimming pools, hot springs, cleaning equipment, medical equipment, etc., for indoor use only.

Product Features

Rating:15A 120VAC/60HZ
Temperature limit:-10~60°C

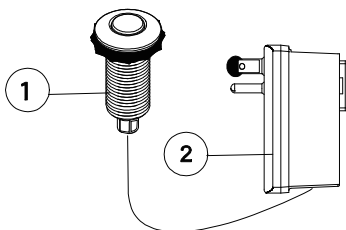

	Part Name	Part No.
1	Sinktop air switch button	CP
		SS
		ORB
		MB
		other

	Part Name	Part No.
2	Air switch socket	ANW2540

Install Instruction

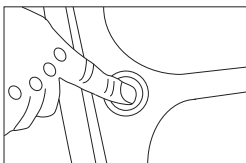

Easily mounts to sink or countertop

PARTS INCLUDED

- Power module with grounded outlet
- Push button with decorative button (As an option)
- Air tubing (6 ft.)

STEP 1. Install the push button set

Loosen plastic nut and metal washer then mount the button directly through a 1-3/8" diameter sink hole (no plumbers putty is required).

Place rubber washer between push button and countertop. The metal washer is optional and is used if the diameter of the sink hole is larger than 1-3/8". Tighten the plastic lock nut completely to the counter to ensure a proper seal.

Notice: for countertops thicker than 1-3/8", install the button with 100% silicone beneath the flange in lieu of the mounting nut.

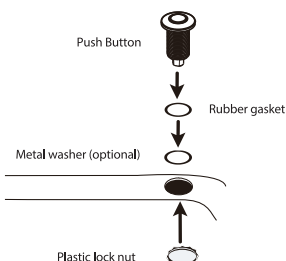

NOTE

With long-term use, food debris may accidentally enter the gaps of the button and cause blockages. Don't worry; simply rotate the metal cover counter clock wise to open it for cleaning and restore its performance.

STEP 2. Attach air tube

Attach air tube between the push button and the power module. Tighten the nut of button shank. Secure tightly.

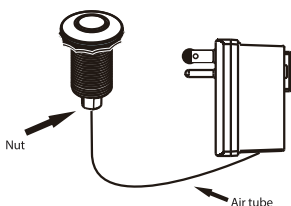

STEP 3. Plug in power module

Plug power module cord into a grounded 120V AC outlet.

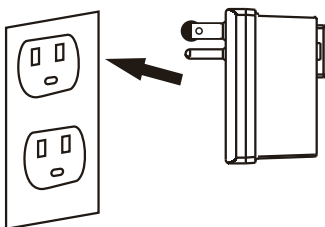

STEP 4. Connect power module and disposal

Plug disposal cord into power module.

Then press and release the air switch button to turn the disposal on.

and release the button again to turn the disposal off.

Test on/off function to ensure the control system operation is proper before using.

CAUTION

Disposal may start when power module is plugged in.

