

welcome to choose **Anwoll**.
Pls read the user manual before application.

AIR SWITCH SOCKET ASS61 SERIES

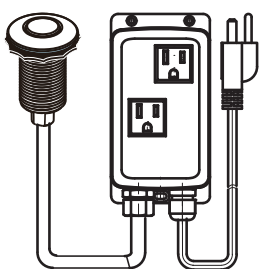

ASS61 is suitable for food waste disposal, swimming pools, hot springs, cleaning equipment, medical equipment, etc., for indoor use only.

Product Features

Rating:12A 125VAC/60HZ
Temperature limit:-10~50°C

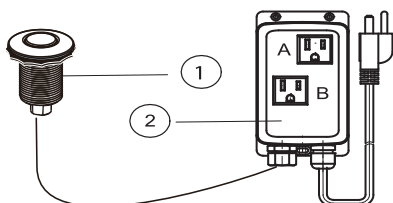

	Part Name	Part No.
1	Sinktop air switch button	CP
		SS
		ORB
		MB
		other

	Part Name	Part No.
2	Air switch socket	ANW2440

Install Instruction

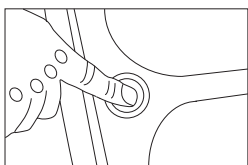

Easily mounts to sink or countertop

PARTS INCLUDED

- Power module with grounded outlet
- Push button with decorative button (As an option)
- Air tubing (6 ft.)

STEP 1. Install the push button set

Loosen plastic nut and metal washer then mount the button directly through a 1-3/8" diameter sink hole (no plumbers putty is required).

Place rubber washer between push button and countertop. The metal washer is optional and is used if the diameter of the sink hole is larger than 1-3/8". Tighten the plastic lock nut completely to the counter to ensure a proper seal.

Notice: for countertops thicker than 1-3/8", install the button with 100% silicone beneath the flange in lieu of the mounting nut.

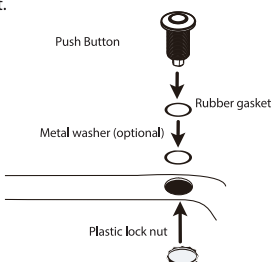

⚠ NOTE

With long-term use, food debris may accidentally enter the gaps of the button and cause blockages. Don't worry; simply rotate the metal cover counter clock wise to open it for cleaning and restore its performance.

STEP 2. Mount Power Module

Mount power module on a cabinet wall within 3 feet of an electrical outlet and electrical appliance. Use two #8 wood screws (not furnished) to secure power module in place.

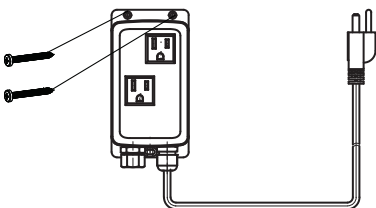

STEP 3. Attach air tube

Attach air tube between the push button and the power module. Tighten the nut of button shank. Secure tightly.

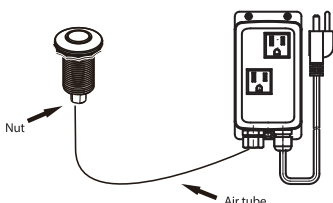

STEP 4. Connect Power Module and Electrical appliance

Plug power module cord into a dedicated, grounded 120V AC outlet that is continuously energized.

Plug disposer and/or hot water dispenser cord into power module.

Press push button to ensure that the sinktop air switch turns the electrical appliance disposer on and off.

Be sure that the control system is operating properly before using the unit.

Press and release the button to turn the electrical appliance on.

Press and release again to turn the electrical appliance off.

⚠ CAUTION

The electrical appliance may start when power module is plugged in. Push the button once to stop the electrical appliance.

