

SPECIFICATIONS

ELECTRONIC LIQUID FLOW SWITCH ANW211FS



Electronic Liquid Flow Switch ANW211FS

Benefits/features

- Gas-liquid dual-use for pneumatic and hydraulic systems
- No moving parts, maintenance-free, easy to install, one model for a variety of pipe diameters
- Continuously adjustable switching quantity, extremely low pressure loss, compact structure, LED display flow trend and switching status
- Can be used for circulating water, cutting fluid and lubricating oil cut-off monitoring, as well as pump idling protection

Basic information

Setting Range	1...150cm/s(Water),3...300cm/s(Oil),20...2000cm/s(Gas)
Flow indication	LED (6pcs)
Setting Type	Potentiometer Setting
Response time	1...13s,Typical value 2s
Connection mode	M12 Socket Connector/Attached 2 meters optional
Initialization time	About 8s
Material	Probe: Stainless steel; Housing: PBT
IP Grade	IP67
Weight	About 0.4kg

Electrical overview

Electrical protection	Reverse, short circuit, overload protection
Signal output	PNP,NPN, Relay Type, NO+NC
Power Supply	24V+20%DC or 230V+15%DC
Turn on current	Max 400mA(PNP,NPN); Max 4A (Relay Type)
No-load current	Max 80mA

Operating conditions

Temperature	Working:-20...+80°C[-4...+176°F] Storage: -20...+100°C[-4...+212°F] Medium:-20...+80°C[-4...+176°F]
-------------	---

Medium temperature change	≤4°C/s
---------------------------	--------

Connection type

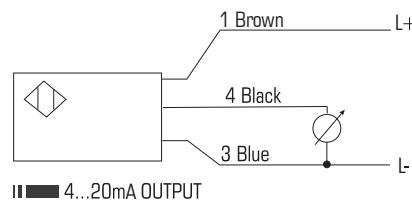
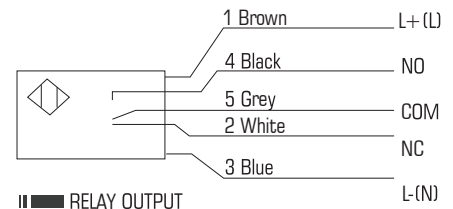
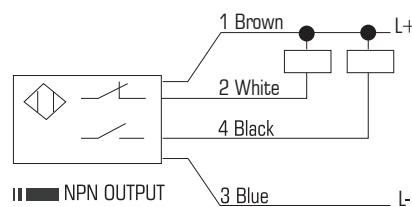

DIMENSIONS & ORDER CODE SELECTION TABLE

ELECTRONIC LIQUID FLOW SWITCH ANW211FS

Dimensions in mm [in]

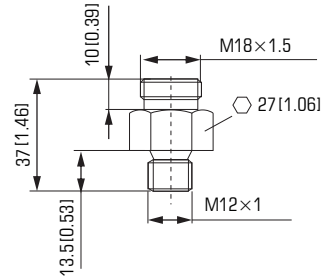
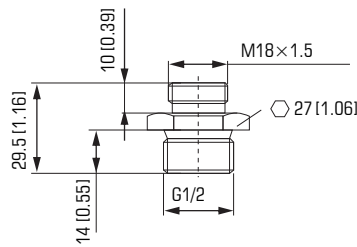
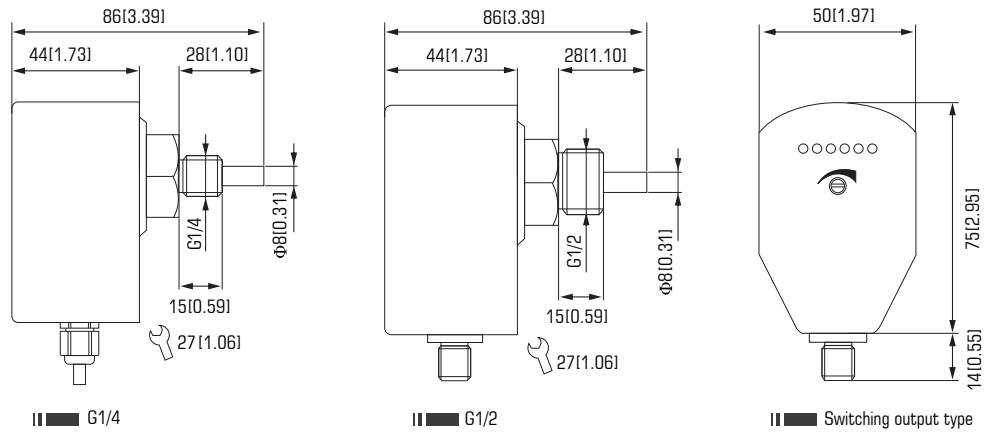

Electronic Liquid Flow Switch ANW211FS

Name	Pressure Connection	Connection Type	Power Supply	Output	Output Method	Connector Type
ANW211FS	V1	H	D	P	R	Q
	G2=G1/2 G4=G1/4	H=Male	A=AC 220V D=DC 24V	P=PNP N=NPN C=Relay	R=NO+NC	Q=Socket

Socket Connector Order Ref No

Socket Connector	Material	Line Length	Female Plug	Shape
ST04	PU	02	F	G
ST04=Self-wiring M12 ET04=Four core M12	PU=PUR	02=2M 05=5M 10=10M	F=Female	G=Straight type W=Curved type